

# iCon Innovation Centre

PROJECT PROFILE

Client WND  
Location Daventry, UK  
Size / Cost 3,700 sqm GIA / £7.2 Million  
Team Structures - SKM Anthony Hunts  
MEP - Synergy Consulting  
Cost - Potter Raper Partnership  
PM - WND / Elev8  
Contractor - Winvic

Awards BCO Regional Award  
Best Commercial Workplace  
EMCBE Construction Excellence  
Civic Trust Awards  
Regional Merit East Midlands  
RIBA Regional Awards  
(Shortlisted)  
Building Awards (Finalist)  
Public Building of the Year  
Green Apple Awards for the Built  
Environment and Architectural  
Heritage: National Silver Winner

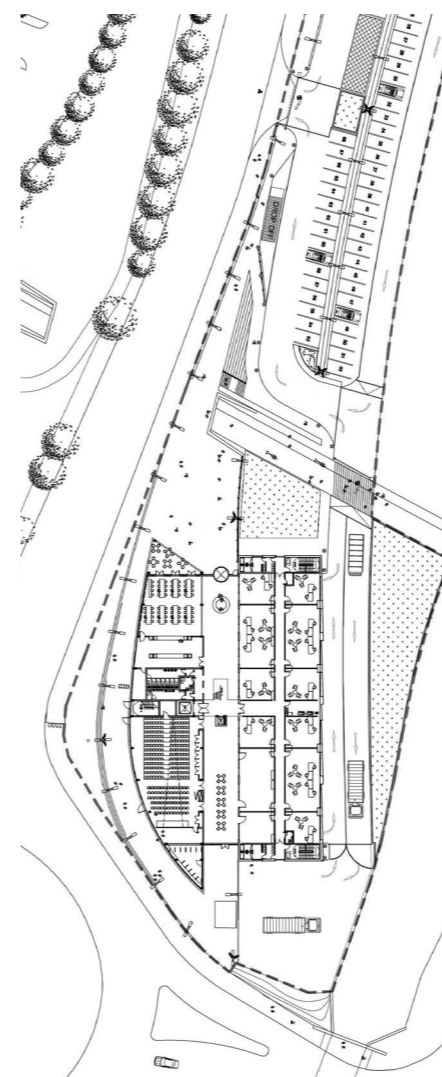

The competition brief called for an iconic building to showcase and provoke innovative thinking and technology in a sustainable manner within a suitable setting. Consarc's winning proposal became the iCon building, a BREEAM Excellent exemplar project. It uses only 12.2 kg of CO<sub>2</sub>/m<sup>2</sup>/yr and demonstrates how maximum energy efficiency and zero carbon status can be achieved. It is an excellent example of the public sector delivering a sustainable building, the quality of which goes some way to delivering a significant change in how the local area is perceived.

### Sustainable Architecture

The iCon is intended to actively promote economic sustainability. It comprises three blocks joined by a central 'street' and triple height foyer atrium. The incubator wing includes 54 commercial units for start-up businesses, the central triple-height ETFE-covered "street" provides exhibition space for small businesses whilst the curved block contains the supporting facilities such as the 300 person lecture theatre, a café and meeting rooms. The building utilises innovative environmental features such as timber frame construction, passive ventilation systems, efficient heat recovery and the first commercial

application of DuPont™ Energain phase-change materials to limit over-heating. These panels absorb ambient heat above 22°C and release it below 18°C. The inclusion of an exhaust air heat pump (EAHP) in association with extract ventilation and passive measures, achieved a significant net saving of £80/sqm on mechanical installations. A key feature of the design is the environmentally responsive façade, constructed from sustainable timber.

**"Since being completed, the iCon has become a popular and critically acclaimed local landmark. Most importantly, it has started to attract new and innovative businesses to the area, which see the iCon as a fitting home for their operations."**

Chris Garden, Director of Regeneration, WND

The iCon's flexible conference and exhibition spaces can be used by the local community for events and performances while occupiers can take advantage of the expert support and advice available from on-site specialists.

Lead Design

ARCHITECTURE