

Lambeth Town Hall & Civic Centre

PROJECT PROFILE



Client London Borough of Lambeth
Location Brixton, London
Size 8,000 + 11,000 sqm; £65 Mio
Team Developer - Muse Developments
Architect - Cartwright Pickard
Structures - Curtins
Services - Chapman BDSP
Cost - Faithful & Gould

Awards RIBA London Award
OAS Development Awards - Best New Build (outside Central London)
BCO London Award - Corporate Workplace (Highly Commended)
Constructing Excellence SECBE - Preservation and Rejuvenation Award
Building Magazine Awards - Project of the Year (shortlisted)
Planning Awards – Best Use of Heritage in Placemaking (shortlisted)
Building Awards - Refurbishment Project of the Year (shortlisted)
NLA Awards - Conservation & Retrofit (shortlisted)

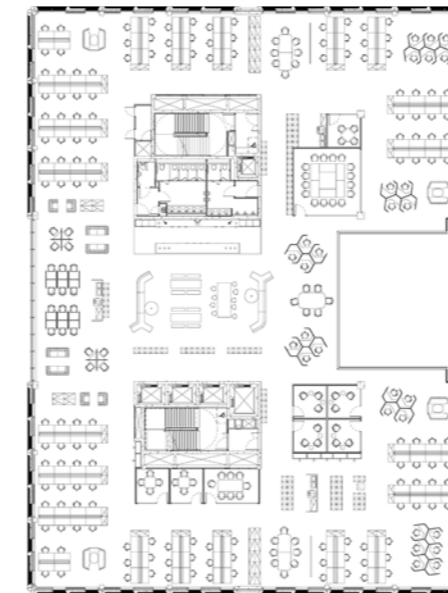

This project was part of Lambeth Council's strategy to use their assets and land more efficiently within a wider mixed-use masterplan that included building 194 new homes, new landscaped public areas, a new Civic Centre with customer services and council offices and the refurbishment of the existing Grade II Town Hall building. We worked alongside the architects, Cartwright Pickard, to provide workplace consultancy services, ensuring the council successfully adapt to their new and refurbished headquarters. Alongside this, we have also provided interior design advice, assisting in the selection of furniture, finishes, arts and graphics and the design of bespoke joinery. Materials and colours were carefully selected to respect the character of the building whilst providing a functional space that reflects the council's spirit and ethos.

The Civic Centre

We provided workplace advice and introduction to new ways of working for the new Civic Centre, a 11,000 m² building of energy efficient, highly flexible workspace. We maximised the potential of the building, providing the council with a civic centre that is more cost effective to run, helping transform working practices to increase staff morale and efficiency.

The Town Hall

Our work on the existing Edwardian Grade II Listed Town Hall reinstated its architectural character while transforming it into a vibrant public building fit for the 21st century with improved public access and building services. Internal spaces include high quality offices and meeting spaces for a local enterprise hub, with the aim to encourage innovation and entrepreneurial spirit.

"The new spaces have delighted visitors and been enthusiastically welcomed by Councillors, staff, and the public. In so doing, the scheme thoroughly embodies the Council's aspirations for Lambeth."

Dan Murray, Senior Programme Manager, Lambeth

Workplace Consultancy
Client Advisory
Interior Design
Furniture Selection

ADVISORY